

LED Gimbal Down Lights

Our new and improved directional LED Gimbal Down Lights, are the perfect solution for a multitude of residential and commercial applications. The adjustable LED gimbal fixtures are 80% more efficient than incandescent luminaires and they are available in multiple trim finish options to match any style of décor.

GDL-3

FEATURES

- Energy efficient – up to 80% energy savings
- High Brightness COB LED's
- Low power consumption
- Warm White and Neutral White color temperatures
- Available in two beam angles
- New Construction, IC and remote installations
- cETLus listed for direct contact with insulation and combustible materials
- Easy to install, modular design
- 50,000 hour life
- 3 year limited warranty

RESIDENTIAL APPLICATIONS

- Kitchens
- Pantries
- Laundry rooms
- Bathrooms

COMMERCIAL APPLICATIONS

- Lobbies
- Hallways
- Elevators
- Stairways
- Retail
- Restaurants
- Office lighting

PRODUCT CODES

GDL - 3 - 9W - ZZ - XX - YY

| LED | BEAM ANGLE | LED Color | TRIM FINISH |
|--------|------------|------------|-------------------------|
| Gimbal | 25° - 25° | WW - 3000K | WH - White Gloss Enamel |
| Down | 36° - 36° | NW - 4000K | BK - Black |
| Light | | | BZ - Bronze |
| | | | SN - Satin Nickel |

Note : WH finish is stock, all other options are special order, MOQ required.



SPECIFICATIONS

| | |
|-------------------|----------------------------------|
| Power Consumption | 9W |
| Input Voltage | 21V DC*, 320mA constant current |
| Beam Angle | 25/36° |
| Color Temperature | |
| WW | 3000K |
| NW | 4000K |
| Lumens | |
| WW | 650 |
| NW | 700 |
| Size (mm) | 43 X 95.5 |
| Approvals | cETLus listed for damp locations |

* Each fixture ships with one constant current power supply.

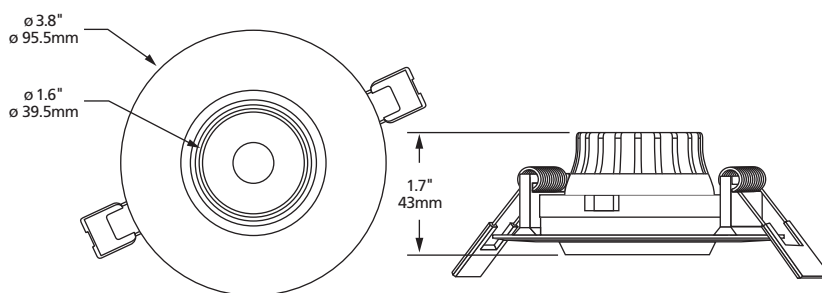

LVLDL-CP-3

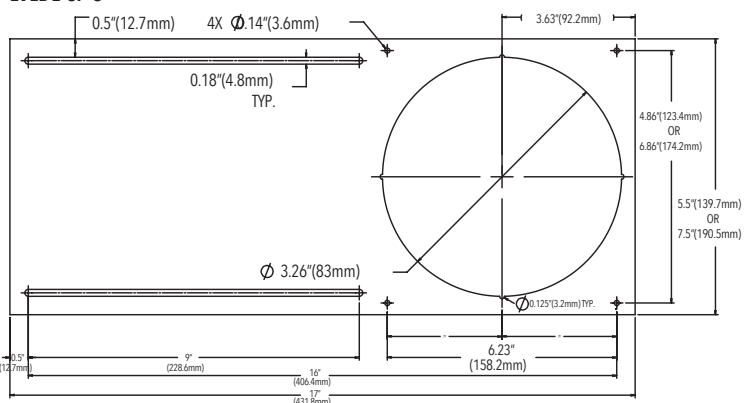

LED Gimbal Down Lights

Our new and improved directional LED Gimbal Down Lights, are the perfect solution for a multitude of residential and commercial applications. The adjustable LED gimbal fixtures are 80% more efficient than incandescent luminaires and they are available in multiple trim finish options to match any style of décor.

GDL-4



FEATURES

- Energy efficient – up to 80% energy savings
- High Brightness COB LED's
- Low power consumption
- Warm White and Neutral White color temperatures
- Available in two beam angles
- New Construction, IC and remote installations
- cETLus listed for direct contact with insulation and combustible materials
- Easy to install, modular design
- 50,000 hour life
- 3 year limited warranty

RESIDENTIAL APPLICATIONS

- Kitchens
- Pantries
- Laundry rooms
- Bathrooms

COMMERCIAL APPLICATIONS

- Lobbies
- Hallways
- Elevators
- Stairways
- Retail
- Restaurants
- Office lighting

PRODUCT CODES

GDL - 4 - 12W - ZZ - XX - YY

LED
Gimbal
Down
Light

BEAM ANGLE
25 - 25°
36 - 36°

LED Color
WW - 3000K
NW - 4000K

TRIM FINISH
WH - White Gloss
Enamel
BK - Black
BZ - Bronze
SN - Satin Nickel

Note : WH finish is stock, all other options are special order, MOQ required.

SPECIFICATIONS

| | |
|-------------------|----------------------------------|
| Power Consumption | 12W |
| Input Voltage | 30V DC*, 320mA constant current |
| Beam Angle | 25/36° |
| Color Temperature | |
| WW | 3000K |
| NW | 4000K |
| Lumens | |
| WW | 870 |
| NW | 930 |
| Size (mm) | 50 X 129.5 |
| Approvals | cETLus listed for damp locations |

* Each fixture ships with one constant current power supply.

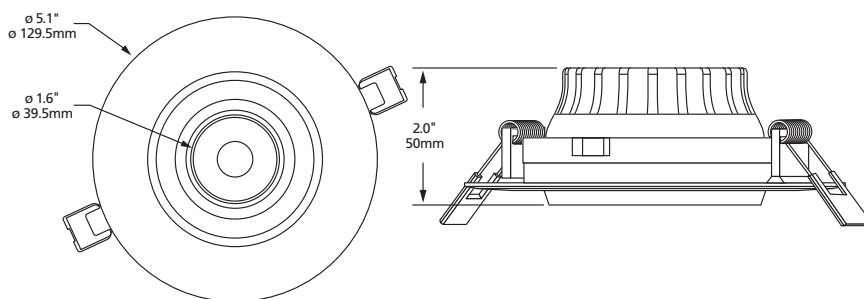

LVLDL-CP-4

